

REASSEMBLY

HINT:

Before reassembly, apply MP grease to the parts indicated by arrows (See page [AT-17](#)).

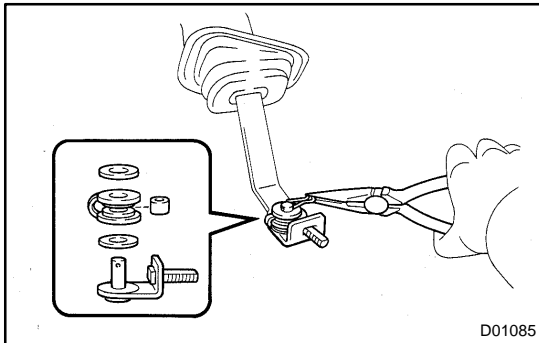

1. INSTALL CLIP, CONNECTING ROD SWIVEL, LOWER CONTROL SHAFT BUSHING, LOWER CONTROL SHAFT PIECE, PLATE WASHER AND SHIFT LEVER BOOT TO CONTROL LEVER

- (a) Install the shift lever boot, 2 plate washers, lower control shaft piece, lower control shaft bushing and connecting rod swivel to the control lever.
- (b) Using pliers, install the clip.

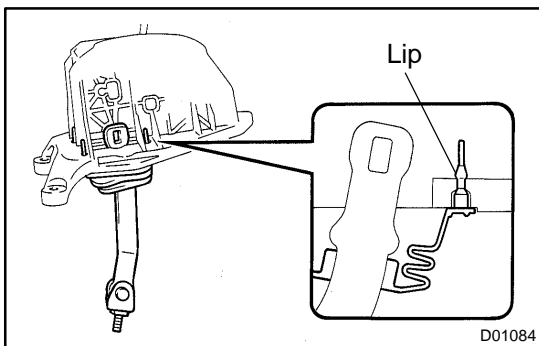

2. INSTALL CONTROL LEVER, SPACER AND CONTROL SHAFT

- (a) Connect the shift lever boot to the shift lever plate.

HINT:

Pull out the 3 lips of the shift lever boot securely, as shown in the illustration.

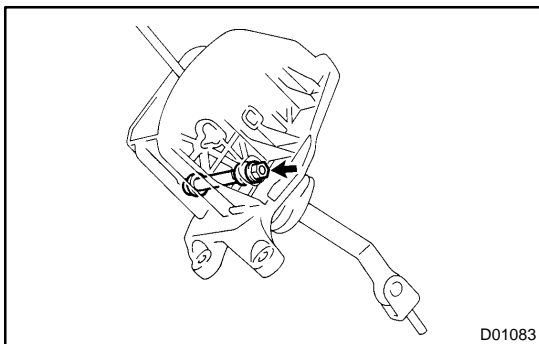

- (b) Install the control shaft and 2 spacers.
- (c) Install and torque the nut.

Torque: 13 N·m (128 kgf-cm, 9 ft-lbf)

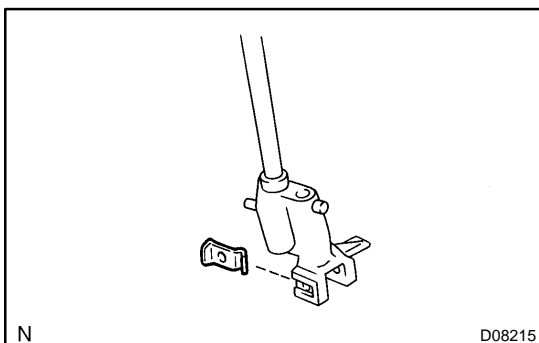

3. INSTALL SHIFT LEVER SUB-ASSEMBLY

- (a) Install a new shift lever nut to the shift lever sub-assembly.

HINT:

Insert the shift lever nut securely until it fits and check there is no looseness.

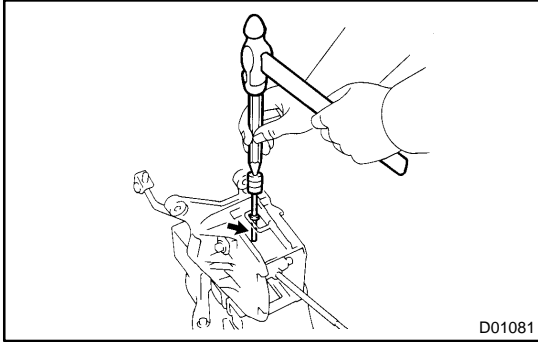

- (b) Install the shift lever sub-assembly.
- (c) Using a pin punch and hammer, drive in the pin.

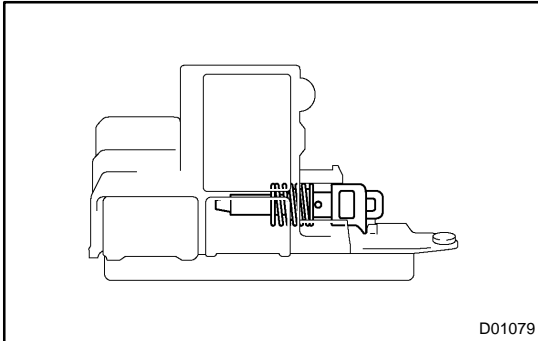

4. INSTALL SHIFT LOCK CONTROL UNIT ASSEMBLY

- (a) Connect the shift lock solenoid link and install a new slotted spring pin.
- (b) Install the compression spring to the shift lock solenoid link.
- (c) Push and install the shift lock solenoid link with the compression spring to the shift lock control unit assembly.
- (d) Install the shift lock control unit assembly.

HINT:

Do not torque the shift lock control unit assembly set screws.

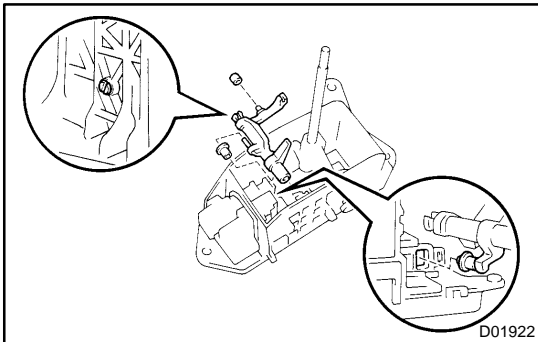

5. INSTALL SHIFT LOCK PLATE STOPPER

- (a) Install the shift lever anti-rattle cushion and shift lock plate stopper cap to the shift lock plate stopper.
- (b) Install the shift lock release spring to the shift lock plate stopper.
- (c) Install the stopper to the shift lever plate.

HINT:

- Check that the claw of the shift lock plate stopper firmly fits in and slides smoothly.
- Insert and connect the projection of the shift lock plate stopper into the square hole of the shift lock control unit assembly.

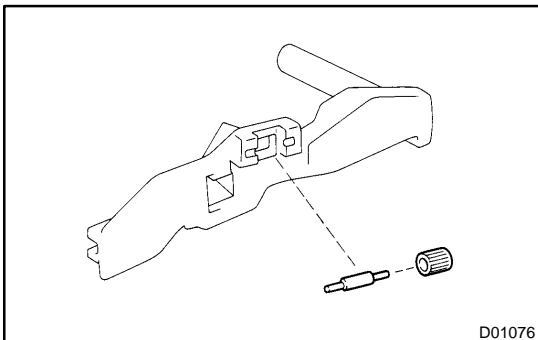

6. INSTALL NO. 1 SHIFT LOCK SWITCH PLATE

- (a) Install the shift lever anti-rattle cushion to the roller.
- (b) Install the roller and shift lever anti-rattle cushion to the plate.

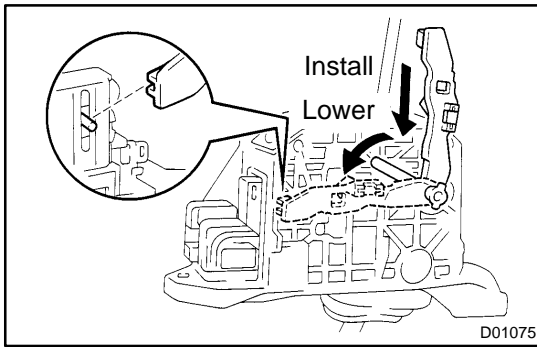

- (c) Install the No. 1 shift lock switch plate in the direction shown in the illustration and lower to the direction shown by an arrow.

HINT:

Connect the groove of the No. 1 shift lock switch plate to the projection of the shift lock control unit assembly.

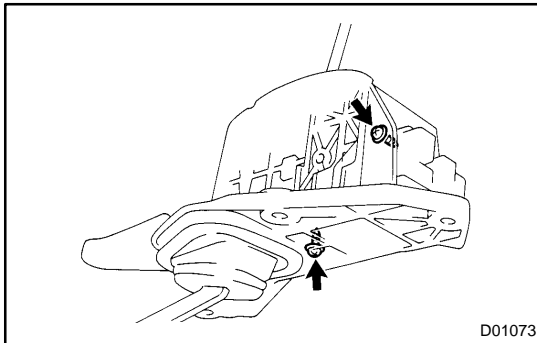

7. INSTALL AND TORQUE 2 SHIFT LOCK CONTROL UNIT ASSEMBLY SET SCREWS

Torque: 2.0 N·m (20 kgf·cm, 17 in.-lbf)

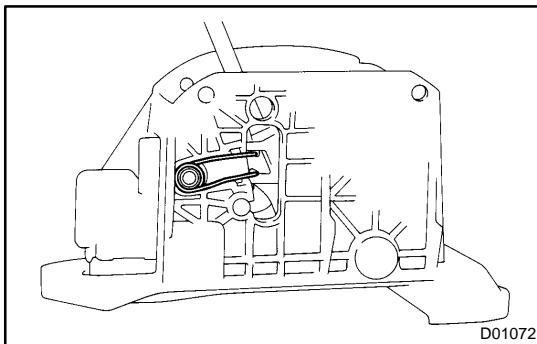

8. INSTALL SPRING HOLDER AND SHIFT LEVER TORSION SPRING

- (a) Install the shift lever torsion spring.

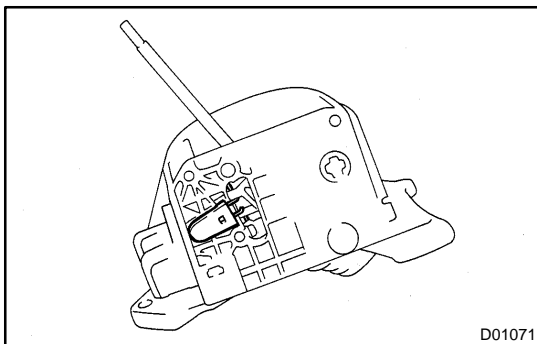

- (b) Install the spring holder.

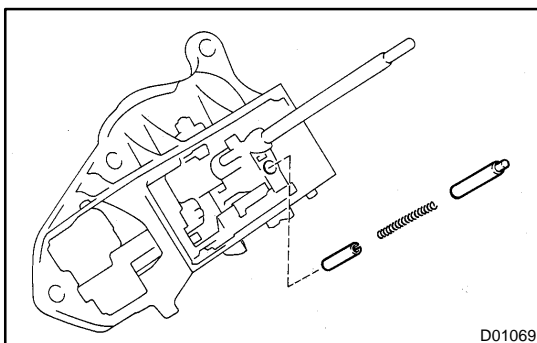

9. INSTALL SHIFT LEVER DETENT PIN, SHIFT LEVER SPRING DAMPER AND COMPRESSION SPRING TO SHIFT LEVER SUB-ASSEMBLY

10. ASSEMBLE INDICATOR LAMP SUB-ASSEMBLY

- (a) Install the terminals of the indicator lamp wire sub-assembly to the connector.
- (b) Install the bulb to the indicator lamp wire sub-assembly.

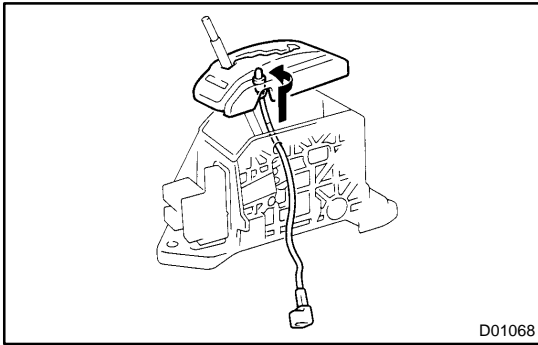

11. INSTALL SHIFT LEVER GUIDE HOUSING AND INDICATOR LAMP SUB-ASSEMBLY

- (a) Install the indicator lamp sub-assembly to the shift lever guide housing.
- (b) Install the shift lever housing with the indicator lamp sub-assembly to the shift lever plate.

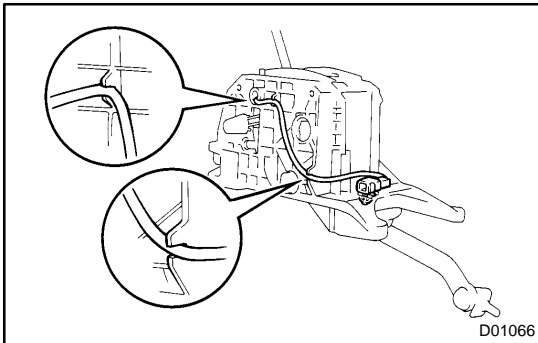

- (c) Connect the indicator lamp wire sub-assembly to the shift lever plate.

HINT:

Hook the indicator lamp wire sub-assembly securely on the retainer of the shift lock plate.

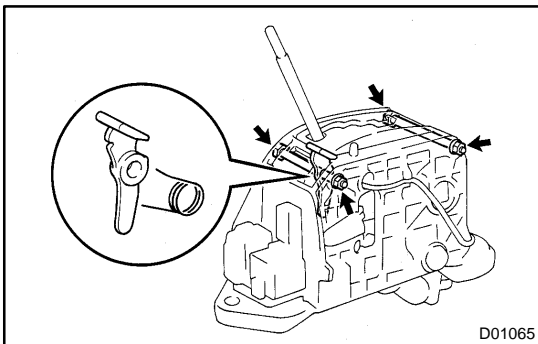

12. INSTALL SHIFT LOCK RELEASE LINK AND SPRING

- (a) Install the shift lock release spring to the shift lock release link.
- (b) Install the 2 shift lever housing set bolts, nuts, shift lock release link and spring.
- (c) Torque the 2 nuts.

Torque: 3.9 N·m (40 kgf·cm, 35 in.-lbf)

13. INSTALL SLIDE COVER

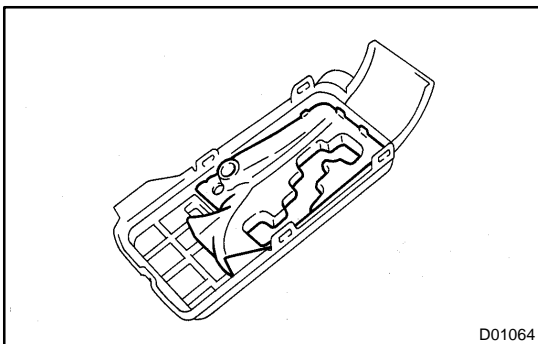

14. INSTALL POSITION INDICATOR LENS TO POSITION INDICATOR HOUSING

HINT:

Fit the 4 claws of the position indicator lens in the grooves of the position indicator housing securely.

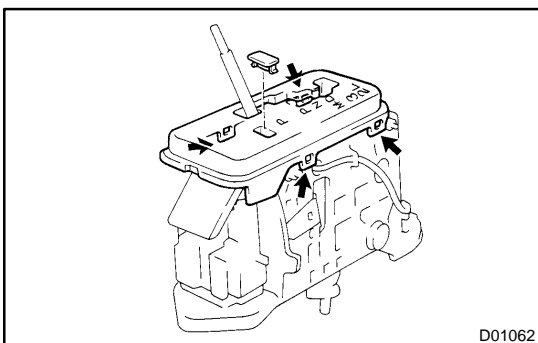

15. INSTALL POSITION INDICATOR HOUSING

- (a) Install the shift lever cap to the position indicator housing.
- (b) Install the position indicator housing to the shift lever plate.

HINT:

Fit the 4 clips of the position indicator housing in the shift lever plate securely.

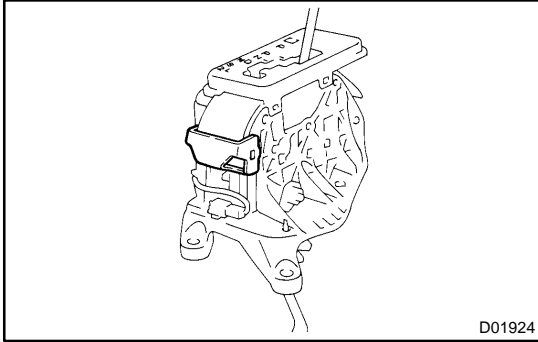

16. INSTALL WIRE PROTECTOR TO SHIFT LEVER PLATE
17. INSTALL SHIFT LEVER KNOB AND SHIFT LEVER KNOB COVER